



The *Polyethylene ball valve HKSF-PE* allows the pipes, unions and stop valve to be installed in a single *PE-HD welded unit*.

Complicated insulation operations become unnecessary. The result is a homogeneous, corrosion-free underground connection with an operating life equal to that of supply pipes. The structural design form of this ball valve - arrived at through numerous test series - is distinguished for its perfect axial force stability, sealing and deformation resistance. The ball shaped design of the housing enables all exterior elements to be absorbed without influencing the operating capacity. The smooth inner surface of the *PE-HD ball valve* ensures a very low pressure loss with optimal flow speed. The gapless inner surface renders sediment deposit impossible and guarantees an unimpeded operation of the valve over many years. The design form of *RMA PE-HD ball valves* offers a operating moment. The seal of the operating handle is designed in such a way that caking, even after a long period in operation, is totally excluded. This is achieved using a special O-ring sealing collar with a relatively limited bearing surface with a specifically high contact pressure.

The switching spindle allows the use of *RMA switching handles* only, which, when a torque of 150 Nm is exceeded, latch out and thus prevent damage to the ball valve.

The double limit stops of the switching square are form-fitted into the housing and support a torque far greater than the limit of the operating handle. For DN 150 for example it is 500 Nm without deformation of the valve housing. This may be explained by the fact that the switching spindle, in contrast to those of our competitors, is not subjected to operating forces. These forces are directly transmitted to the housing by the switching square.

*RMA ball valves, type HKSF-PE* are supplied in complete sets containing:

Ball valve, switching handle with square protector 14 or 27/32 and switching handle protection pipe.

Due to the solid construction special installation regulations are not necessary. *RMA ball valves, type HKSF-PE* require absolutely no maintenance.

**Design features** Housing and weld-on ends of PE-HD, switching handle of Keripol - fibreglass reinforced, switching spindle of Hostaform (POM), ball of Hostaform (POM), seals of all gas resistant Perbunan, pressure rating gas PN 4.

**Polyethylene ball valve  
Type HKSF-PE**

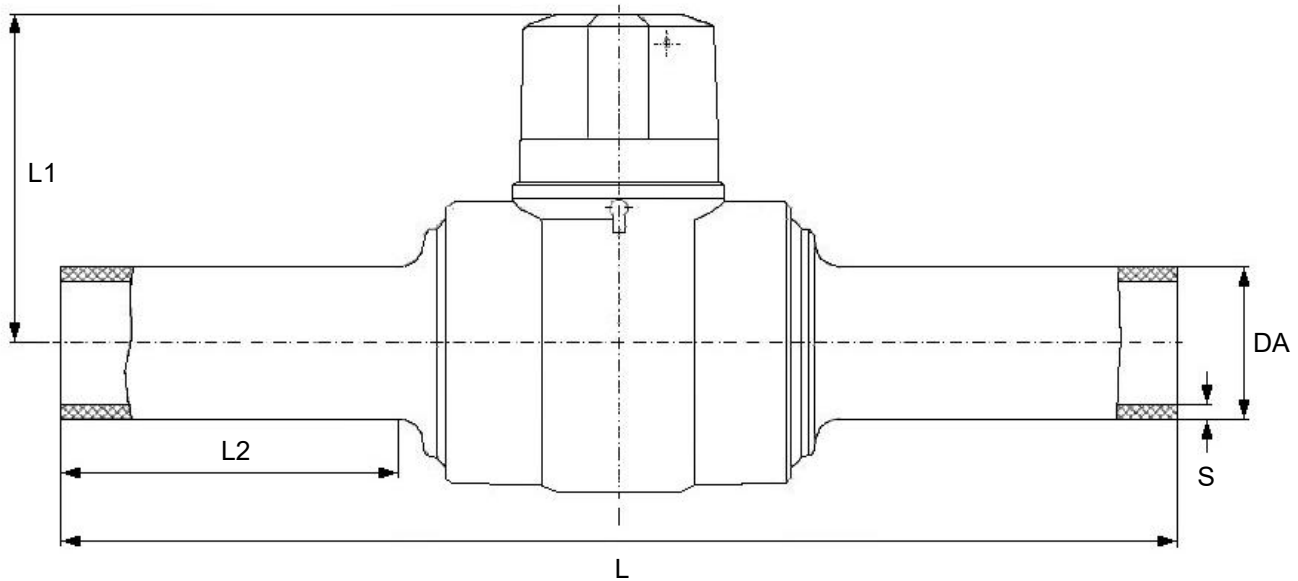

Item no.	DN mm	DA PE-pipe mm	S thickness mm	L mm	L1 mm	L2 mm
217-1050	25	32,3	3,1	280	96	80
217-1051	32	40,3	3,8	280	96	80
217-1052	40	50,3	4,7	370	108	112
217-1053	50	63,3	5,9	370	108	112
217-1054	80	90	8,2	530	136	154
217-1055	100	110	10	530	136	154
217-1056	100	125	11,4	530	168	145
217-1057	150	160	14,6	680	185	210
217-1058	150	180	16,4	680	185	210
217-1060	200	200	18,2	680	185	210
217-1061	200	225	20,5	680	185	210



CERT

## DVGW-Baumusterprüfzertifikat DVGW type examination certificate

DG-4394BU0008

Registriernummer  
registration number

<b>Anwendungsbereich</b> <i>field of application</i>	Produkte der Gasversorgung <i>products of gas supply</i>
<b>Zertifikatinhaber</b> <i>owner of certificate</i>	RMA Rheinau GmbH & Co.KG Forsthausstraße 3, D-77866 Rheinau
<b>Vertreiber</b> <i>distributor</i>	RMA Rheinau GmbH & Co.KG Forsthausstraße 3, D-77866 Rheinau
<b>Produktart</b> <i>product category</i>	Gasarmaturen: Absperrarmatur aus PE-HD (4394)
<b>Produktbezeichnung</b> <i>product description</i>	Kugelhahn in Durchgangsform aus Polyethylen hoher Dichte (PE 100)
<b>Modell</b> <i>model</i>	HKSF-PE 100
<b>Prüfberichte</b> <i>test reports</i>	Kontrollprüfung Labor: 14/1090/4394/984 vom 28.11.2014 (EBI)
<b>Prüfgrundlagen</b> <i>test basis</i>	DVGW VP 302 (01.06.2006)

**Ablaufdatum / AZ** 22.01.2018 / 14-0773-GNV  
*date of expiry / file no.*

08.01.2015 Rie A-1/2

Datum, Bearbeiter, Blatt, Leiter der Zertifizierungsstelle  
*date, issued by, sheet, head of certification body*

DVGW CERT GmbH ist von der DAkkS nach DIN EN 45011:1998  
akkreditierte Stelle für die Zertifizierung von Produkten der Energie- und  
Wasserversorgung.

DVGW CERT GmbH is an accredited body by DAkkS according to EN  
45011:1998 for certification of products for energy and water supply industry.



Deutsche  
Akkreditierungsstelle  
D-ZE-16028-01-01

DVGW  
DVGW CERT GmbH  
Zertifizierungsstelle

Josef-Wirmer-Str. 1-3  
53123 Bonn

Tel. +49 228 91 88 - 888  
Fax +49 228 91 88 - 993

www.dvgw-cert.com  
info@dvgw-cert.com

A-2/2

DG-4394BU0008

Gasart <i>gas category</i>	Bemerkungen <i>remarks</i>
Brenngase nach G260	

Typ <i>type</i>	Technische Daten <i>technical data</i>	Bemerkungen <i>remarks</i>
HKSF-PE 100	Nennweite: d 32 max. Betriebsdruck: 10 bar	
HKSF-PE 100	Nennweite: d 40 max. Betriebsdruck: 10 bar	
HKSF-PE 100	Nennweite: d 50 max. Betriebsdruck: 10 bar	
HKSF-PE 100	Nennweite: d 63 max. Betriebsdruck: 10 bar	
HKSF-PE 100	Nennweite: d 90 max. Betriebsdruck: 10 bar	
HKSF-PE 100	Nennweite: d 110 max. Betriebsdruck: 10 bar	
HKSF-PE 100	Nennweite: d 125 max. Betriebsdruck: 10 bar	
HKSF-PE 100	Nennweite: d 160 max. Betriebsdruck: 10 bar	
HKSF-PE 100	Nennweite: d 180 max. Betriebsdruck: 10 bar	

**zertifizierte Bauteile / Werkstoffe**

*certified components*

Registr.-Nr. <i>registration no.</i>	Bauteil (Produktart) <i>component</i>	Modell/Typ <i>model/type</i>	Hersteller <i>manufacturer</i>
NG-5162BN0547	Schmierstoff für Gasgeräte	KLÜBERSYNTH UH1 64-2403/KLÜBERSYNTH UH1 64-2403	Klüber Lubrication München SE & Co. KG
NG-5112AQ7138	Dichtungswerkstoff aus Elastomeren für Gasgeräte und -anlagen	WILLBRALIT@WILLBRALIT@WILLBRANDT KG	

**Verwendungshinweise / Bemerkungen**

*hints of utilization / remarks*

Anschlussart: beiderseitig Rohrstützen aus PE 100